

**Taxilane C7 Repaving Project**

Taxilane C7 between Terminals Six and Seven will be closed for asphalt paving from 0001L, October 20<sup>th</sup>, 2018, to 2359L on October 22<sup>th</sup>, 2018. The purpose of this work is to repair extensive rutting and depressions along the centerline and main gear tracks of Taxilane C7. This work will be completed by the LAWA Paving Crew.

This closure impacts the following airlines operating in Terminal 6 and Terminal 7: Alaska Airlines, Air Canada, and United Airlines.

Terminal 6 Gates:

- Closed- Gates 60, 62, 64, 66, 68A
- Impacted- Gate 68B remains open (B737-800 and smaller) with a modified lead-in line

Terminal 7 Gates:

- Closed- Gates 71A, 71B, 73, 75A, 75B
- Impacted- Gate 77 remains open with a modified lead-in line

Alaska and United Airlines will be accommodated at the West Remote Gates and will be supported by LAWA Bus Operations.

Affected Air Canada flights will be accommodated at Terminal 5 during the 72 hour closure.

Thank you for your support. For questions or comments regarding this advisory please contact Airside Manager, Jeff Mort, [Jmort@lawa.org](mailto:Jmort@lawa.org).

**Issue Date: 10/11/18****Subject: Taxilane C7 Repaving Project**

\*The LAX Operations Advisory will be posted on LAWA's Airport Operations website and can be retrieved at <http://www.lawa.org/airops.aspx>



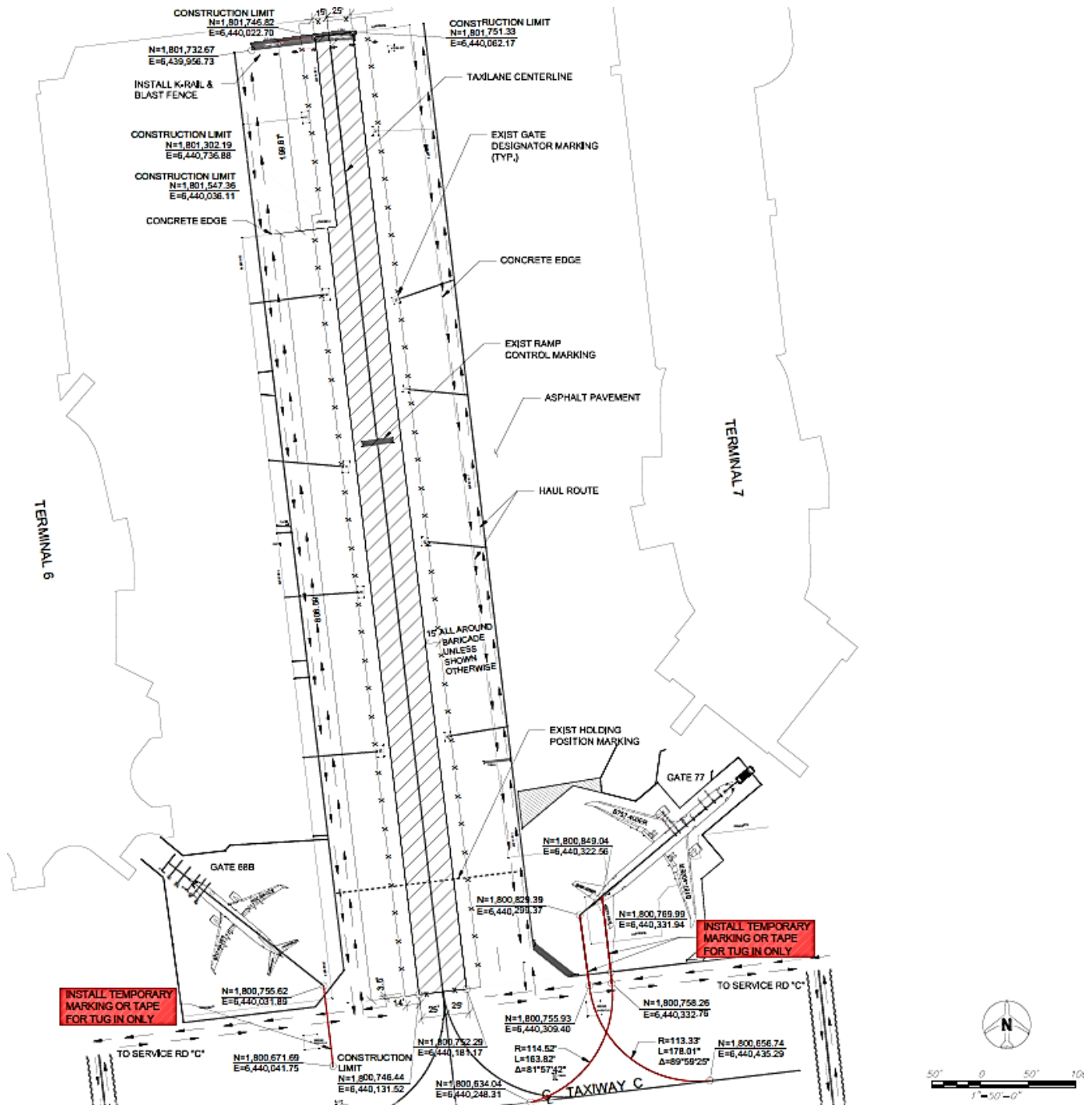

**Issue Date: 10/11/18**

**Subject: Taxiway C7 Repaving Project**

\*The LAX Operations Advisory will be posted on LAWA's Airport Operations website and can be retrieved at <http://www.lawa.org/airops.aspx>



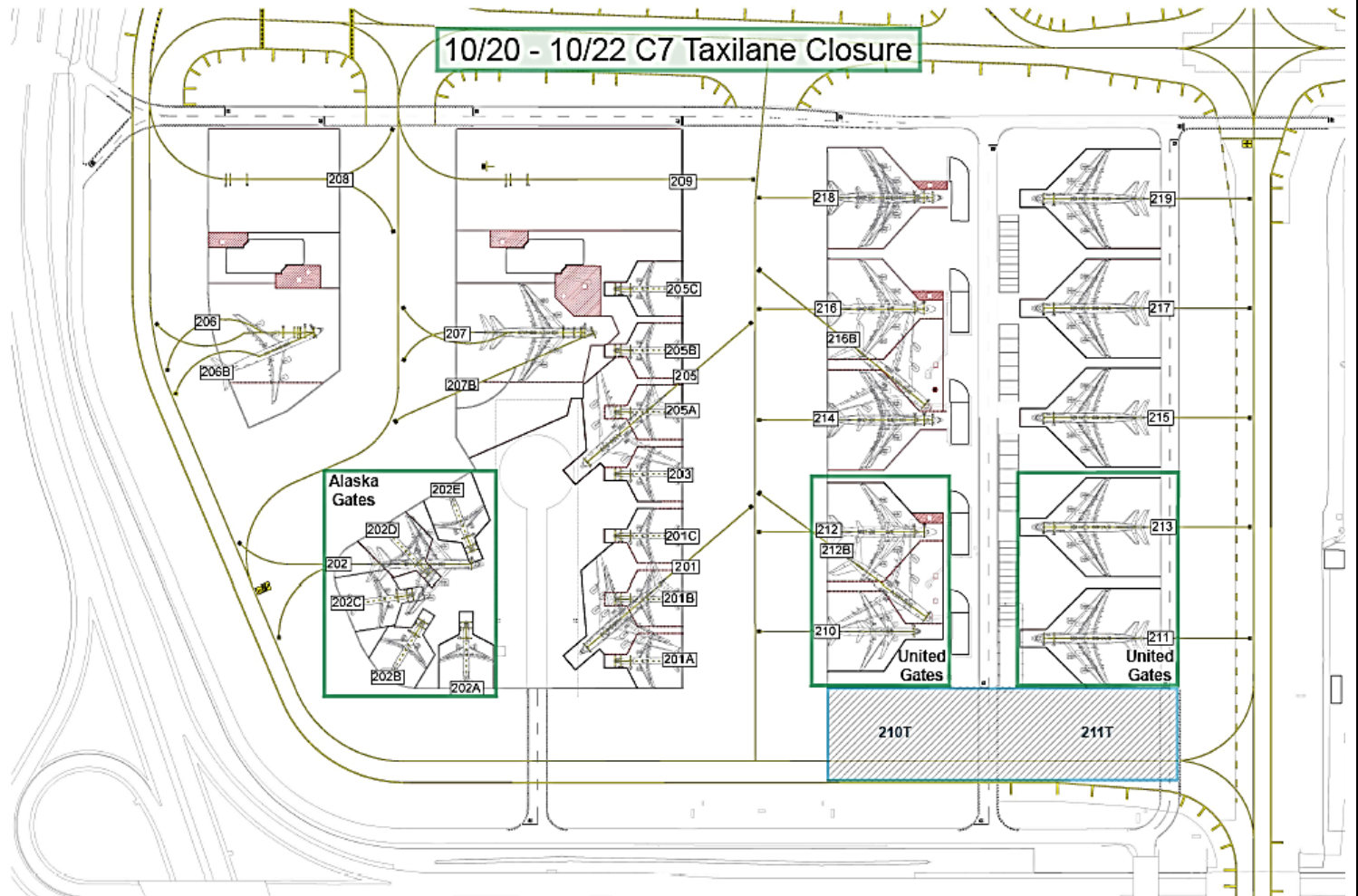

**Issue Date: 10/11/18**

**Subject: Taxilane C7 Repaving Project**

\*The LAX Operations Advisory will be posted on LAWA's Airport Operations website and can be retrieved at <http://www.lawa.org/aiops.aspx>

