

Daily Taxiway Closures – Taxiway A Shoulder Repaving (Update #2)

Taxiway A will be closed daily for shoulder asphalt repaving over the course of several weeks. This work will be completed in several phases, and the affected segments of Taxiway A will be closed during the daytime work hours for each phase. Please see the updated closure schedule below and attached exhibit outlining the work areas.

Closure Schedule

Phase 1: Complete.

Phase 2: Taxiway A closed between Taxilane A2 and Taxilane A3. Delayed due to weather. An updated schedule for Phase 2 will be provided at a later date.

Phase 3A: Taxiway A closed between Taxilane A1 and Taxilane A2, Jan. 28th-31st 2019, 0730-1430L. Taxilane A1 apron will not be accessible for aircraft during the work hours.

Phase 3B: Taxiway A closed between Taxiway F and Taxilane A1. Delayed due to conflicting work projects. An updated schedule for Phase 3B will be provided at a later date.

Phase 4: Taxiway A closed between Taxiway F and Taxilane A3, Feb. 25th-**Mar. 01st 2019**, 0730-1430L. Taxilane A2 apron will not be accessible for aircraft during the work hours.

Phase 5: Taxiway A closed between Taxilane A2 and Taxilane A3, Mar. 4th-6th 2019, 0730-1430L. Taxilane A3 apron access restricted during the work hours.

A Notice to Airmen (NOTAM) will be issued 72 hours prior to the scheduled closures. Please plan your flight operations accordingly. For current airfield operating conditions please check NOTAMs at <https://pilotweb.nas.faa.gov>. Thank you for your support.

For questions or comments regarding this advisory please contact Airside Manager, Jeff Mort, Jmort@lawa.org.

Issue Date: February 22, 2019

Subject: Daily Taxiway Closures – Taxiway A Shoulder Repaving

*The LAX Operations Advisory will be posted on LAWA's Airport Operations web site and can be retrieved at <http://www.lawa.org/airops.aspx>



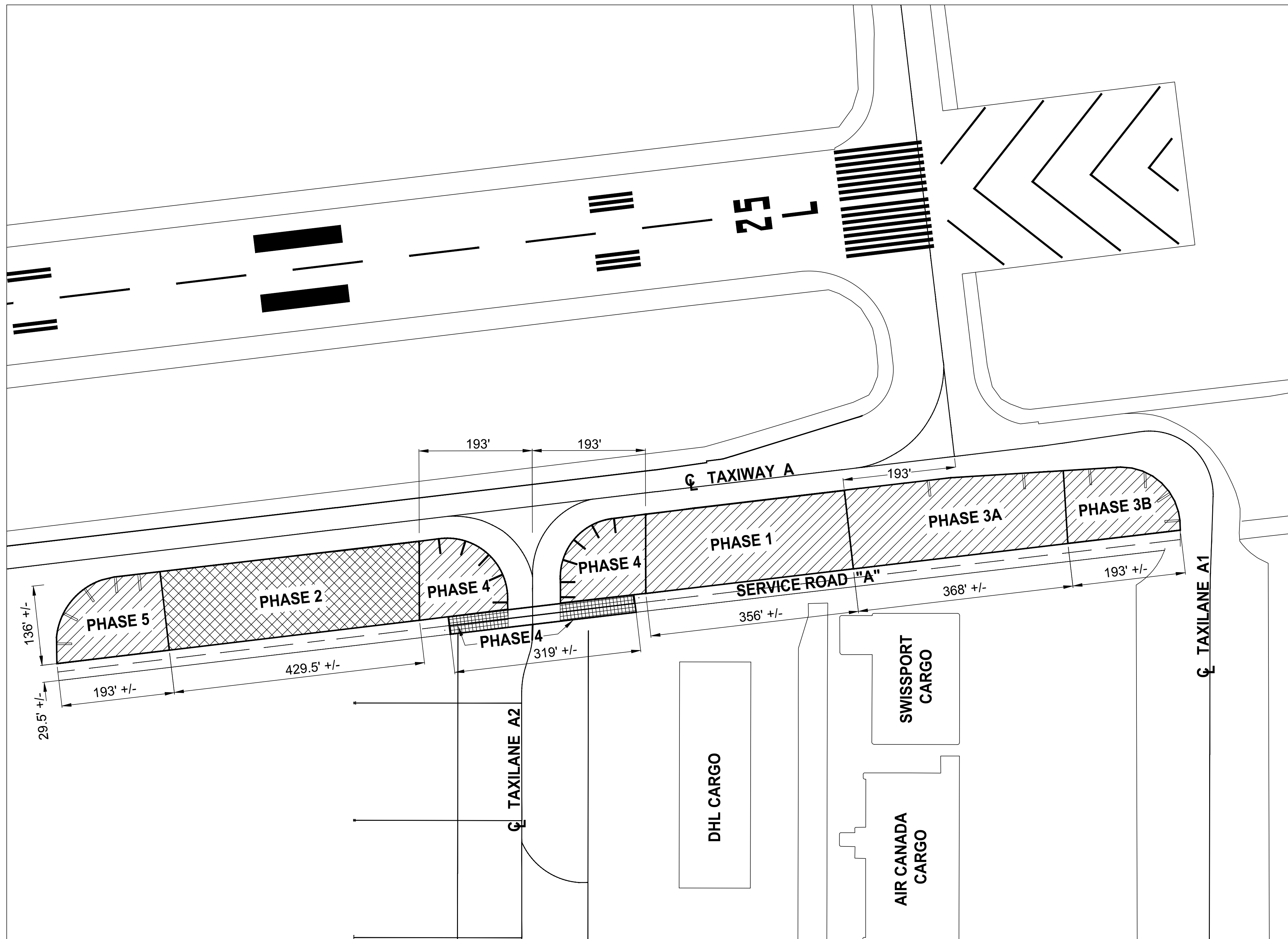

SITE PLAN
SCALE: 1"=100'-0"

| INDEX OF DRAWINGS | | |
|-------------------|-------------|---|
| SHEET NUMBER | SHEET TITLE | SHEET DESCRIPTION |
| 1 | G-1 | COVER SHEET |
| 2 | C-1 | SITE PLAN AND DRAWING INDEX |
| 3 | C-2 | PHASE 1 - PAVEMENT REHABILITATION PLAN |
| 4 | C-3 | PHASE 2 - PAVEMENT REHABILITATION PLAN |
| 5 | C-4 | PHASE 3A - PAVEMENT REHABILITATION PLAN |
| 6 | C-5 | PHASE 3B - PAVEMENT REHABILITATION PLAN |
| 7 | C-6 | PHASE 4 - PAVEMENT REHABILITATION PLAN |
| 8 | C-7 | PHASE 5 - PAVEMENT REHABILITATION PLAN |
| 9 | C-8 | PHASE 1 - PAVEMENT MARKING PLAN |
| 10 | C-9 | PHASE 2 - PAVEMENT MARKING PLAN |
| 11 | C-10 | PHASE 3A - PAVEMENT MARKING PLAN |
| 12 | C-11 | PHASE 3B - PAVEMENT MARKING PLAN |
| 13 | C-12 | PHASE 4 - PAVEMENT MARKING PLAN |
| 14 | C-13 | PHASE 5 - PAVEMENT MARKING PLAN |
| 15 | C-14 | PAVEMENT MARKING DETAIL |
| 16 | C-15 | PHASE 4 - TEMPORARY AIRCRAFT ROUTE PLAN |
| 17 | C-16 | PHASE 5 - TEMPORARY AIRCRAFT ROUTE PLAN |

20180054-01-C1.dwg 12/18/2018

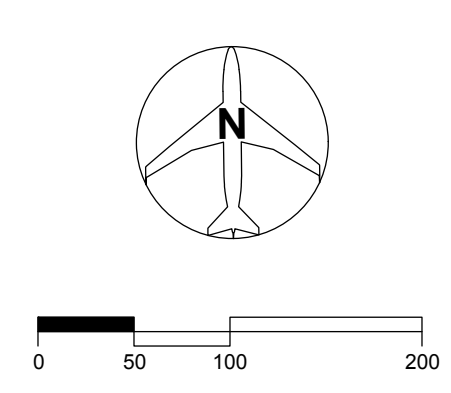

| | | | | |
|-------------------------------|--|-------------------------|-------|--|
| | Los Angeles World Airports | | | |
| | SHOULDER & SURFACE RD REPAIR AT TWY "A" & SERVICE RD "A" | | | |
| | SITE PLAN & DRAWING INDEX | | | |
| | LOS ANGELES INTERNATIONAL AIRPORT | | | |
| SUBMITTED BY | | APPROVED BY | | |
| ASST. CHIEF AIRPORTS ENGINEER | | CHIEF AIRPORTS ENGINEER | | |
| DRAWN | CHECKED | PLAN SET NUMBER | SHEET | |
| NWG | DH | 02 OF XX | C-1 | |
| SCALE | DATE | DWG NO. | | |
| AS NOTED | 12-19-2018 | | | |
| GRID LOCATIONS | FILE NAME | 20180054-02 | | |
| TO | 20180054 | | | |